



4 Way Surge Secure Power Protector Extension Cord

2 x 3 Pin Sockets / 1 x Contour Socket / 1 x Euro Socket 250V ~ 16A

3m LEAD

2 Year Warranty
claim period

High Surge Protection
R30 000 Warranty

Repair or Replace warranty terms and conditions apply.



Product Code: FBWPX4/3
Barcode: 6002844069285

(4) Bulk Barcode: 16002844069282

Overview

Don't risk losing your valuable equipment through a surge, protect it with the 4 Way Surge Secure Power Protector Extension Cord. It has a built-in mains tester (see *LED indicator lights*) which checks that the wiring in the wall socket is safe to use or if there are possible wiring faults, as well as checking that the plug is working correctly. Quicker reaction time ensures full protection from power surges. This product does not protect against direct lightning strikes.



FIRE RESISTANT

Manufactured with flame retardant materials. Tested to the highest South African standards.

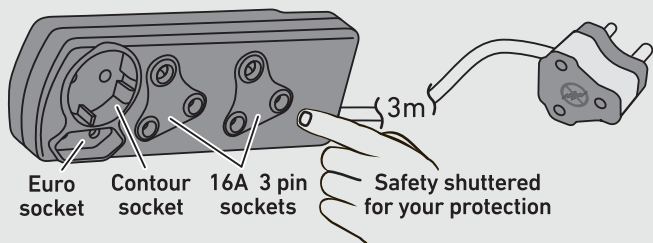

Packaging Dimensions

Height	292mm	Weight	0.7 kg
Depth	90mm	Qty	1
Width	242mm		

Packaging Contents

- 1 x 4 Way Surge Secure Power Protector Extension Cord 3m
- 1 x Surge warranty form

The Ellies warranty is only valid for the Surge Secure Power Protector product if it is used in South Africa and for domestic use only.

Mains tester LED indicators

Surge Secure Power Protector Plug has a built-in mains checker, which indicates if there are possible wiring faults. Indicator lights show that the Surge Protector is working correctly.

Illuminated Non-illuminated

If **all** the Surge Secure plug lights are **OFF** when the wall socket switch is **OFF**, then switch **ON** the wall socket switch and the following applies:



Correct Surge Secure



No earth

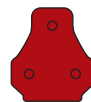

No live



Live and neutral reversed

If **any** of the Surge Secure plug lights are **ON** when the wall socket switch is **OFF**, then switch **ON** the wall socket switch and the following applies:



Live and earth reversed



Faulty neutral



Live and neutral reversed



Faulty earth



Overload circuit fused wires

Specifications

Max total combined surge current (Amps)	18 000 - 24 000
Max total combined surge energy (Joules)	500 - 700
Protection component response time (nSec)	< 25
Max connected load	3680W
Cable	3G 1.5mm
Lead length	3m
Amps	16A
Volts	250V ~